

PM2-500/PM2-500V



Passive deflecting mirrors for 2-beam Multiple light beam safety devices

The PM2-500 and PM2-500V are each designed for use as the deflecting mirror unit for ROBUST Multiple light beam safety devices RRT42 and RRT22. The integrated, optically aligned mirror system ensures simple mounting and alignment, substantially decreasing the start-up time as compared with single mirrors.

Used in combination with ROBUST Multiple light beam safety devices, **PM2-500** is suited for sensing zone widths of up to 2,5 m. The integrated mirror system is able to tolerate deviations in vertical alignment.

With its expanded mirror system, the **PM2-500V** used in combination with ROBUST Multiple light beam safety devices can handle sensing zone widths of up to 8 m. The V-mirror system tolerates not only vertical but also axial deviations in alignment.



Leuze electronic GmbH + Co. KG

Liebigstrasse 4
82256 Fuerstenfeldbruck, Germany
Phone +49 8141 5350-0
Telefax +49 8141 5350-190
info@leuze.de
www.leuze.com

Areas of application

In combination with the 2-beam Multiple light beam safety devices ROBUST RRT 22 and RRT42 for safeguarding access as well as for safeguarding danger zones, e.g. at palletizing systems and in warehouse and conveyor technology.

Advantages

- Easy alignment due to integrated, optically aligned mirror system
- Operating ranges of 0.5 m - 2.5 m (PM2-500) or 1.5 m - 8 m (PM2-500V)
- Enclosed profile housing prevents contamination of and damage to the mirrors
- Adjustable M6 sliding brackets for fast and easy mounting
- PM2-500 tolerates vertical deviations in alignment
- PM2-500V tolerates both vertical and axial deviations in alignment

Dimensional Drawings

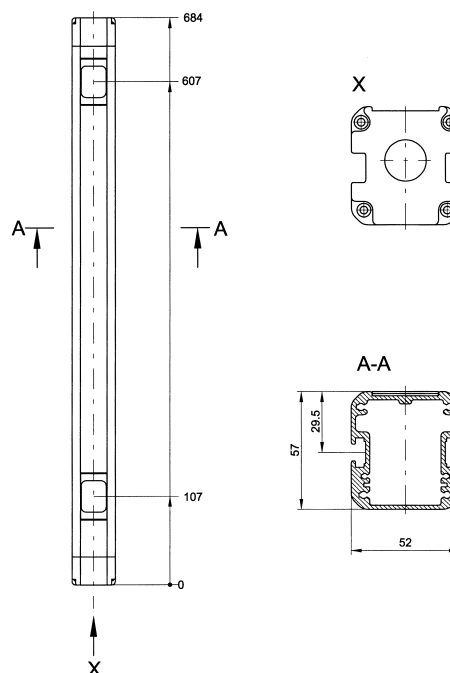

Note

Do not use cleaning agents containing solvents to clean the glass covering the light openings. Clean only with a soft cleaning cloth.

Order Details

Type	Art. no.
Passive deflecting mirror PM2-500	50029088 *
Passive deflecting mirror PM2-500V	909661 *

* 2 standard mounting brackets, 2 M6 sliding nuts and screws included

Accessories

Type	Art. no.
Swivelling mount with absorption of vibration (2 pieces per unit necessary)	560300
Mounting column UDC-1000-S1 (height 1060 mm)	549827
Mounting column UDC-1300-S1 (height 1360 mm)	549828
Mounting column UDC-1600-S1 (height 1660 mm)	549814
Mounting column UDC-1900-S1 (height 1960 mm)	549829